

HGFT-EX

Oil level indicators



ELESA Original design



HGFT-EX



HGFT/SL-EX

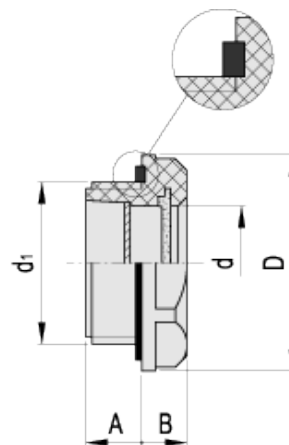

technical informations

Material

Polyamide based (PA) technopolymer. Resistant to solvents, oils, greases and other chemical agents.

Colour

Black, glossy finish.

Window

Transparent polyamide based (PA-T/AR) technopolymer. Resistant to alcohol, solvents, oils with additives, greases, acids and alkali.

Flat packing ring

NBR synthetic rubber.

Standard executions

- HGFT-EX: with matte anodised aluminium star-shaped contrast screen with red central level point.
- HGFT/SL-EX: without contrast screen.

ATEX directive compliance

The level indicators of the HGFT-EX series comply with Health and Safety Requirements intended in 94/9/EC ATEX European Directive (explosive atmospheres) for equipments in Group II, category 2GD. Level indicators have "kX" protection degree and can therefore be mounted in equipments protected by means of "immersion in liquid", without lowering protection degree.

II 2 G D k T6 X, marked on the HGFT-EX level indicators, represents the identification according to ATEX directive.

II: group of substances for which the product is suitable

2: identification of the category

G: identification of the type of explosive atmosphere (Gases or vapours)

D: identification of the type of explosive atmosphere (Dust)

kX: protection degree by means of immersion in liquid

IIB: explosive gases group (only for HGFT.16)

T6: temperature class

Ambient and/or fluid temperature: $-30 \div +80^{\circ}\text{C}$

The declaration of conformity to European Directives of this product is available and it is part of the product itself.

Accessories on request

Brass nut type [GH](#) for fitting to reservoirs with wall thickness smaller than 5 mm.

Note

For use with fluids containing special additives, please contact ELESA Sales Department.

Standard Elements		Main dimensions						Tightening torque	Weight
Code	Description	d ₁	A	B	D	d	s	[Nm]	g
14441-EX	HGFT.10-3/8-C9-EX	G 3/8	8	7	24	11	22	4÷8	4
14461-EX	HGFT.13-1/2-C9-EX	G 1/2	10	8.5	28	14.5	24	6÷8	6
14481-EX	HGFT.16-3/4-C9-EX	G 3/4	9.5	8.5	35	18	32	8÷10	10

Standard Elements		Main dimensions						Tightening torque	Weight
Code	Description	d ₁	A	B	D	d	s	[Nm]	g
14446-EX	HGFT.10/SL-3/8-C9-EX	G 3/8	8	7	24	11	22	4÷8	3
14466-EX	HGFT.13/SL-1/2-C9-EX	G 1/2	10	8.5	28	14.5	24	6÷8	5
14486-EX	HGFT.16/SL-3/4-C9-EX	G 3/4	9.5	8.5	35	18	32	8÷10	9



ELESA and GANTER models all rights reserved in accordance with the law. Always mention the source when reproducing our drawings.

STANDARD MACHINE ELEMENTS WORLDWIDE