

GN 6341-NI

Washers

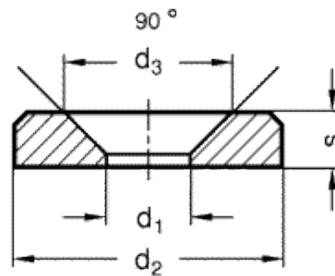

INOX
Stainless Steel

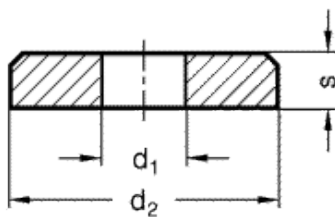
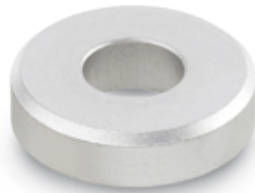

technical informations

Material

AISI 303 stainless steel NI, turned.

Finish

Matte blasted, MT.

Standard versions available

- Type A: with cylindrical bore.
- Type B: with bore for countersunk screw.

Features and applications

Washers GN 6341-NI are used mainly in mechanical machine and jig construction when DIN 125, DIN 9021 and DIN 6340 washers no longer meet requirements.

Standard Elements	Main dimensions				Weight
Description	$d_1 +0.5/+0.2$	d_2	d_3	s	g
GN 6341-NI-4-10-A-MT	4	10	-	2.5	1

GN 6341-NI-4-10-B-MT	4	10	8.4	2.5	1
GN 6341-NI-4-13-A-MT	4	13	-	2.5	2
GN 6341-NI-4-13-B-MT	4	13	8.4	2.5	2
GN 6341-NI-5-13-A-MT	5	13	-	3	2
GN 6341-NI-5-13-B-MT	5	13	10.5	3	2
GN 6341-NI-5-16-A-MT	5	16	-	3	4
GN 6341-NI-5-16-B-MT	5	16	10.5	3	4
GN 6341-NI-6-15-A-MT	6	15	-	4	4
GN 6341-NI-6-15-B-MT	6	15	12.6	4	3
GN 6341-NI-6-20-A-MT	6	20	-	4	9
GN 6341-NI-6-20-B-MT	6	20	12.6	4	8
GN 6341-NI-8-20-A-MT	8	20	-	5	10
GN 6341-NI-8-20-B-MT	8	20	16.8	5	9
GN 6341-NI-8-26-A-MT	8	26	-	5	18
GN 6341-NI-8-26-B-MT	8	26	16.8	5	16
GN 6341-NI-10-25-A-MT	10	25	-	6.5	20
GN 6341-NI-10-25-B-MT	10	25	21	6.5	15
GN 6341-NI-10-32-A-MT	10	32	-	6.5	36
GN 6341-NI-10-32-B-MT	10	32	21	6.5	31
GN 6341-NI-12-30-A-MT	12	30	-	7.5	33
GN 6341-NI-12-30-B-MT	12	30	25.2	7.5	25
GN 6341-NI-12-40-A-MT	12	40	-	7.5	65
GN 6341-NI-12-40-B-MT	12	40	25.2	7.5	60



STANDARD MACHINE ELEMENTS WORLDWIDE