

GN 536

Knurled nuts

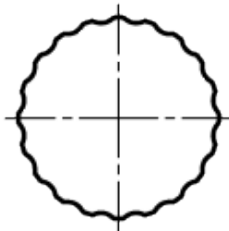

INOX
Stainless Steel

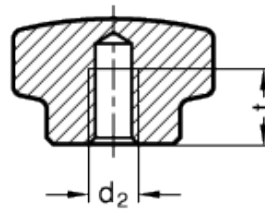
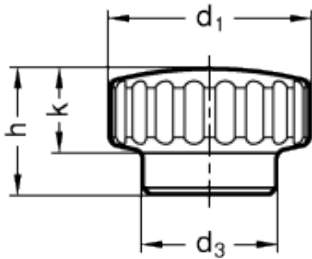

technical informations

Material

- AISI 304 stainless steel.
- Version MT: matt blasted
- Version PL: polished

Assembly

Tapped blind hole.

Features and applications

The knurling of the Stainless steel-Knurled nuts GN 536 allows a use in an environment with hygienic requirements.

Standard Elements	Main dimensions				Mounting hole		Weight
Description	d ₁	d ₃	h	k	d ₂	t _{min.}	g
GN 536-20-M5-MT	20	14	13	8.5	M5	8	26
GN 536-20-M5-PL	20	14	13	8.5	M5	8	26
GN 536-24-M6-MT	24	16	15	10.5	M6	9	38
GN 536-24-M6-PL	24	16	15	10.5	M6	9	38
GN 536-28-M8-MT	28	18	17	12.5	M8	10	58
GN 536-28-M8-PL	28	18	17	12.5	M8	10	58



STANDARD MACHINE ELEMENTS WORLDWIDE